

800L Offal Bin

Very Efficient Nesting ¹

Stacks Full ²

Forklift Rotatable ³

Low Wall Height Fill

Design Strength:

- **Tough LDPE - 10mm thickness**
- **Box Section Top Rim**
(no open edge to crack from)
- **¹Continuous Nesting Rim**
(less wall flex and more strength)

FDA Approved Food Grade LDPE

Mould In Graphics

(company + numbering options)

Single Skin or ²Twin Skin Stackable Lid



65mm Drainage Bung

³Galv Steel Fork Insert option

Full Specifications on Page 2 below



Designed and manufactured in New Zealand

800L Offal Bin

Standard Heavy Duty 1000mm high Option 1

Code	BN217
Volume	800L
Height	1000 mm
Top Rim	1165 x 1165 mm
Base	880 x 880 mm
Wall Thickness	10mm
Material	LDPE

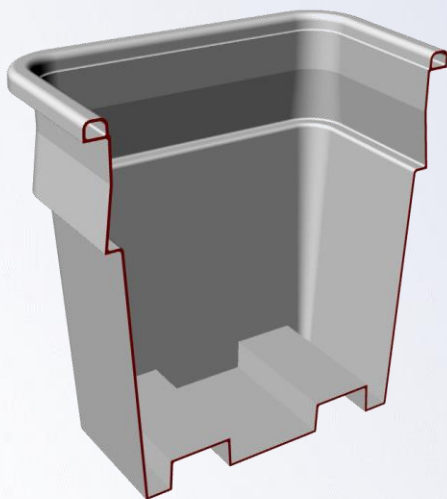
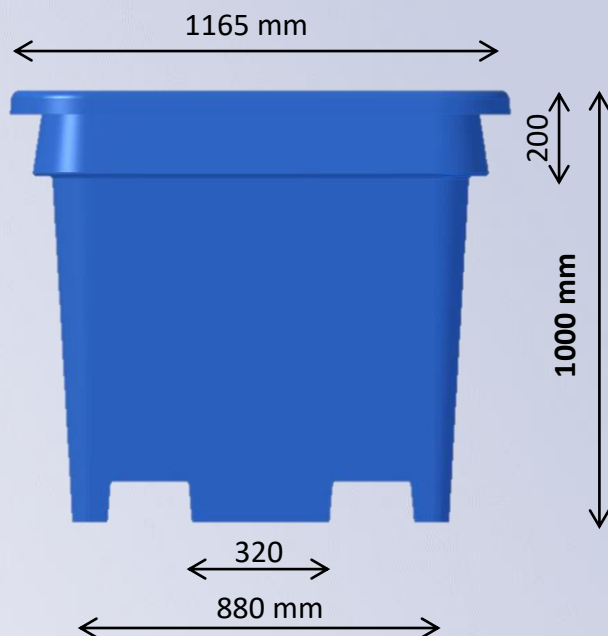

[Light Weight Slimline Option Page 3](#)

Designed and manufactured in New Zealand

800L Offal Bin

Light Weight 950mm high Option 2

Code	BN238
Volume	800L
Height	950 mm
Top Rim	1150 x 1165 mm
Base	880 x 880 mm
Wall Thickness	8mm
Material	LDPE

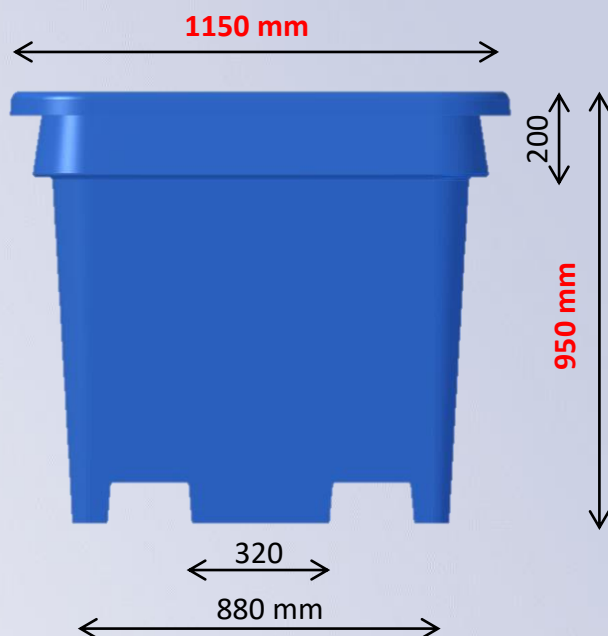

Imaged with
Twin Skin Stackable Lid



Rotate Empty using
Galv Steel Fork Inserts

